



NF E 11-099.
Type 1
for models
6 to 10 mm or type 2 for
all other models

Measuring inserts
for application
range
6 to 10 mm: steel,
hardened to HV30 550.
10 to 300 mm:
tungsten carbide tipped to
HRC ≥ 70.

Wooden case

Identification
number

Declaration
of conformity

Calibration
certificate
upon request

ROCH ALESOMETER with Analogue Indication. Metric

Bore gauges with 3-line contact. All ROCH ALESOMETER let you measure not only through bores, but also blind bores as well as centring shoulders, except for the models covering the application range 6 to 10 mm.

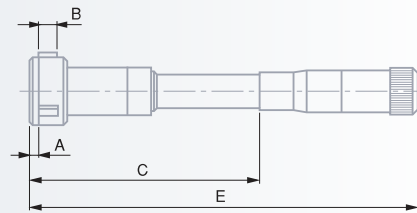
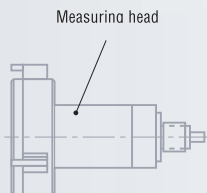
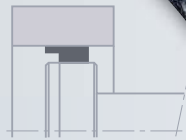

Single Bore Gauges. complete

No	mm	mm	µm	mm			
				A mm*	B mm	C mm	E mm
0081725001	6 ÷ 8	0.001	4	1.2	3	54.5	107
0081725003	8 ÷ 10	0.001	4	1.2	3	54.5	107
0081725006	10 ÷ 12.5	0.001	4	0.3	6.5	64.5	117
0081725008	12.5 ÷ 15	0.001	4	0.3	6.5	64.5	117
0081725010	15 ÷ 17.5	0.001	4	0.3	6.8	64.5	117
0081725012	17.5 ÷ 20	0.001	4	0.3	6.8	64.5	117
0081725014	20 ÷ 25	0.001	4	0.3	8.5	70	122.5
0081725016	25 ÷ 30	0.001	4	0.3	8.5	70	122.5
0081725018	30 ÷ 35	0.001	4	0.3	8.5	70	122.5
0081725020	35 ÷ 40	0.001	4	0.3	8.5	70	122.5
0081725022	40 ÷ 50	0.001	4	0.3	14.5	108.7	188.7
0081725024	50 ÷ 60	0.001	5	0.3	14.5	108.7	188.7
0081725026	60 ÷ 70	0.001	5	0.3	14.5	108.7	188.7
0081725028	70 ÷ 85	0.001	5	0.3	14.5	126.7	206.7
0081725030	85 ÷ 100	0.001	5	0.3	14.5	126.7	206.7
0081725032	100 ÷ 125	0.01	7	0.3	30	153.7	233.5
0081725034	125 ÷ 150	0.01	7	0.3	30	153.7	233.5
0081725036	150 ÷ 175	0.01	8	0.3	30	153.7	233.5
0081725038	175 ÷ 200	0.01	8	0.3	30	153.7	233.5
0081725040	200 ÷ 225	0.01	9	0.3	30	153.7	233.5
0081725042	225 ÷ 250	0.01	9	0.3	30	153.7	233.5
0081725044	250 ÷ 275	0.01	9	0.3	30	153.7	233.5
0081725046	275 ÷ 300	0.01	9	0.3	30	153.7	233.5

* Not applicable for models from 10 mm since the measuring inserts are close to the micrometer front face.

ROCH ALESOMETER with Analogue Indication – Full Metric Sets



NF E 11-099. Type 1 for models 6 to 10 mm or type 2 for all other models.



Measuring inserts for application range 6 to 10 mm: steel, hardened to HV30 550. 10 to 300 mm: tungsten carbide tipped to HRC ≥ 70.



For any additional data, see on page D-11



Wooden case



Identification number



Declaration of conformity



Calibration certificate upon request

No	mm	No	mm	No	mm	No	mm
Full sets including		Single bore gauges		Setting rings		Extensions	
0081725063	6 ÷ 10	0081725001	6 ÷ 8	0211625101	8	0081625081	100
		0081725003	8 ÷ 10				
0081725066	10 ÷ 20	0081725006	10 ÷ 12.5	0211625102	12.5	0081625082	100
		0081725008	12.5 ÷ 15	0211625103	17.5		
		0081725010	15 ÷ 17.5				
		0081725012	17.5 ÷ 20				
0081725068	20 ÷ 40	0081725014	20 ÷ 25	0211625104	25	0081625083	150
		0081725016	25 ÷ 30	0211625105	35		
		0081725018	30 ÷ 35				
		0081725020	35 ÷ 40				
0081725070	40 ÷ 100	0081725022	40 ÷ 50	0211625106	45	0081625084	150
		0081725024	50 ÷ 60	0211625107	60		
		0081725026	60 ÷ 70	0211625109	85		
		0081725028	70 ÷ 85				
		0081725030	85 ÷ 100				
0081725072	100 ÷ 150	0081725032	100 ÷ 125	0211625111	125	0081625085	200
		0081725034	125 ÷ 150				

Extensions



Hardened steel. Insulated body against hand warmth.



Identification number



Declaration of conformity

Setting rings



NF E 11-011. type A2



Steel, hardened to 60 HRC



Bore related tolerance $\pm (3 \mu\text{m} + 10 \cdot 10^{-6} \cdot D) \mu\text{m}$



D = Nominal diameter in mm $(1 \mu\text{m} + 5 \cdot 10^{-6} \cdot D) \mu\text{m}$



Shipping box



Identification number



Calibration certificate upon request

Extensions for Depth Increase

No	mm	mm
0081625081	6 ÷ 10	100
0081625082	10 ÷ 20	100
0081625083	20 ÷ 40	150
0081625084	40 ÷ 100	150
0081625085	100 ÷ 300	200

ROCH Settina Rinas

No	mm	No	mm
0211625101	8	0211625110	90
0211625102	12.5	0211625111	125
0211625103	17.5	0211625112	150
0211625104	25	0211625113	175
0211625105	35	0211625114	200
0211625106	45	0211625115	225
0211625107	60	0211625116	250
0211625109	85	0211625117	275